



Pallet stacker
pedestrian controlled

Logos Light - Logos ac



Logos "light" has been particularly projected for medium-light applications. Its compact dimensions allow easy movements also in narrow spaces. It is available with simplex mast at 1.650 mm and duplex mast at 2.900 mm.

Versatile and manoeuvrable, Logos ac is the ideal pedestrian operated lift truck for standard applications. It has been completely renewed with a 0.7 kW ac traction motor and a high level electronic control which grant manoeuvrability and power during all working conditions to be used also on gradual ramps. The new steering system allows to make more agile manoeuvres in narrow spaces and working aisles less than 2.250 mm.

Chassis

Of folded frame construction to minimize welding-induced stresses, it offers maximum stability and superior mechanical strength under all traction and storage conditions. The configuration with four fixed points of support offers unique lateral stability. With its easy-adjustment system, the pivoting wheel helps maintain excellent grip, offsetting wear on the drive wheel. The bolted masts and laterally positioned steering handle ensure wide visibility during storage, picking and transport operations. The battery compartment is accessed by simply lifting the hinged lid, thus facilitating daily and periodical battery checks and recharging. Particular attention has been given to provide easy access to wearing parts in order to minimize routine maintenance costs.

Masts

OMG masts are made of cold-drawn sections to ensure torsion and bending rigidity, available in simplex and duplex with a nominal capacities of 1.000 and 1.200 Kg.



The pumps are very efficient with low noise level. The standard minijoystick on tiller arm (Logos ac only) allows the operation without taking the hands off the steering handle.

Drive

Reliable and powerful traction motor capable of meeting the most demanding performance requirements, delivering the necessary power under all load conditions as the translation speed exactly depends on the position of the drive throttle.

Electronic system

Logos ac is equipped with ac controller and energy recover achieved by:

- releasing the drive throttle;
- reversing the direction of travel.

This control monitor all the machine's functions and allow many adjustments to optimise the performance of the machine, adapting it to the type of work it has to carry out, ensuring low energy consumption and noiseless operation.

Characteristics				OMG S.r.l.			
				Logos Light	Logos ac		
1.1	Manufacturer						
1.2	Model						
	Execution						
1.3	Drive			Electric	Electric		
1.4	Operator type			Pedestrian	Pedestrian		
1.5	Load capacity / rated load	Q	t	1.0	1.2		
	Load capacity mast lift	Q	t	/	/		
	Load capacity initial lift	Q	t	/	/		
	Load capacity initial lift + mast contemporaneously	Q	t	/	/		
1.6	Load centre distance	c	mm	600	600		
1.8	Load distance (centre of load axle to fork face)	x	mm	700	680		
1.9	Wheelbase	y	mm	1.350	1.350		
Weights	2.1	Service weight incl. battery (see line 6.5)		kg	660	770	
	2.2	Axle loading, laden front/rear		kg	530 / 1.130	630 / 1.340	
	2.3	Axle loading, unladen front/rear		kg	452 / 208	528 / 242	
Wheels Chassis	3.1	Tires			polyurethane	polyurethane	
	3.2	Tire size, front		mm	85	85	
	3.3	Tire size, rear		mm	190	245	
	3.4	Additional wheels dimensions			mm	150	150
	3.5	Wheels, number front / rear (x = driven wheels)			n°	1x + 1 / 2-4*	1x + 1 / 2-4*
	3.6	Track width, front	b10	mm	520	520	
	3.7	Track width, rear	b11	mm	380	380	
Basic dimensions	4.2	Mast lowered height		h1	mm	2.005	2.005
	4.3	Free lift		h2	mm	85	85
	4.4	Lift height		h3	mm	2.815	2.815
	4.5	Mast extended height		h4	mm	3.400	3.400
	4.6	Initial lift		h5	mm	/	/
	4.9	Height of tiller arm in drive position min. / max.		h14	mm	840 / 1.295	840 / 1.295
	4.15	Forks lowered height		h13	mm	85	85
	4.19	Overall length		l1	mm	1.905	1.905
	4.20	Length to face of forks		l2	m	754	754
	4.21	Overall width		b1/ b2	mm	800	800
	4.22	Forks dimensions		s/e/l	mm	70 / 180 / 1.150	70 / 180 / 1.150
	4.25	Width over forks		b5	mm	560	560
	4.32	Ground clearance, centre of wheelbase		m2	mm	15	15
	4.33	Aisle width for pallets 1000 x 1200 crossways		Ast	mm		
	4.34	Aisle width for pallets 800 x 1200 lengthways		Ast	mm	2.227	2.227
4.35	Turning radius		Wa	mm	1.545	1.545	
Performances	5.1	Travel speed laden / unladen		km/h	2.8 / 3.3	4.5 / 5.2	
	5.2	Lifting speed laden / unladen		m/s	0.12 / 0.20	0.11 / 0.20	
	5.3	Lowering speed laden / unladen		m/s	0.30 / 0.17	0.31 / 0.18	
	5.8	Max gradient performance		%		7 / 10	
	5.10	Service brake			Electromagnetic	Electromagnetic	
Electric motors	6.1	Traction motor, rating S2 60 min		kW	0.7	0.7	
	6.2	Lift motor, rating S3 15%		kW	2	2	
	6.3	Battery according to DIN 43531 / 35 / 36 A, B, C, no			no	DIN 43531	
	6.4	Battery voltage, nominal capacity K5		V/Ah	2x12 / 100	24 / 160 - 250*	
	6.5	Battery weight		kg	2 x 30	144	
	6.6	Energy consumption according to VDI cycle		kW/h		1.00	
Others	8.1	Type of drive control			DC	ac	
	8.4	Sound level at driver's ear according to EN 12 053		dB(A)	< 70	< 70	

* option

Technical specification according to VDI 2198, technical values are referred to the standard product. Different masts, different tires, additional equipment, etc. could produce other values. Information and data are given for information only, OMG S.p.A. will have the sole right for technical changes and improvements without giving any notice.

Accessories and special executions Logos Light

double load wheels	built-in charger 24V 10A
push button for vertical operation	semi-traction batteries
standard	option

Accessories and special executions Logos ac

double load wheels	anti roll-back system
push button for vertical operation	electronic speed control
supertrack traction wheel	electronic brake system
no-marking rubber traction wheel	electromagnetic parking brake
polyurethane traction wheel	BDI hourmeter with lifting cut-off at 80% discharge
automatic battery refilling	built-in charger 24V 20A
pin access keypad	
standard	option

Standard masts						Logos Light	Logos ac	
Denomination		Mast lowered height	Lift height	Total lift height	Mast extended height	Free lift	Capacity (t)	Capacity (t)
		h_1	h_3	h_3+h_{13}	h_4	h_2	(t) c=600 mm	(t) c=600 mm
Simplex	mm	2.085	1.565	1.650	2.085	/	1.0	1.2
Duplex	mm	2.005	2.815	2.900	3.400	/	0.8	1.0
	mm	2.355	3.515	3.600	4.100	/	*	0.8
	mm	2.655	4.115	4.200	4.700	/	*	0.4

* masts not available for Logos Light

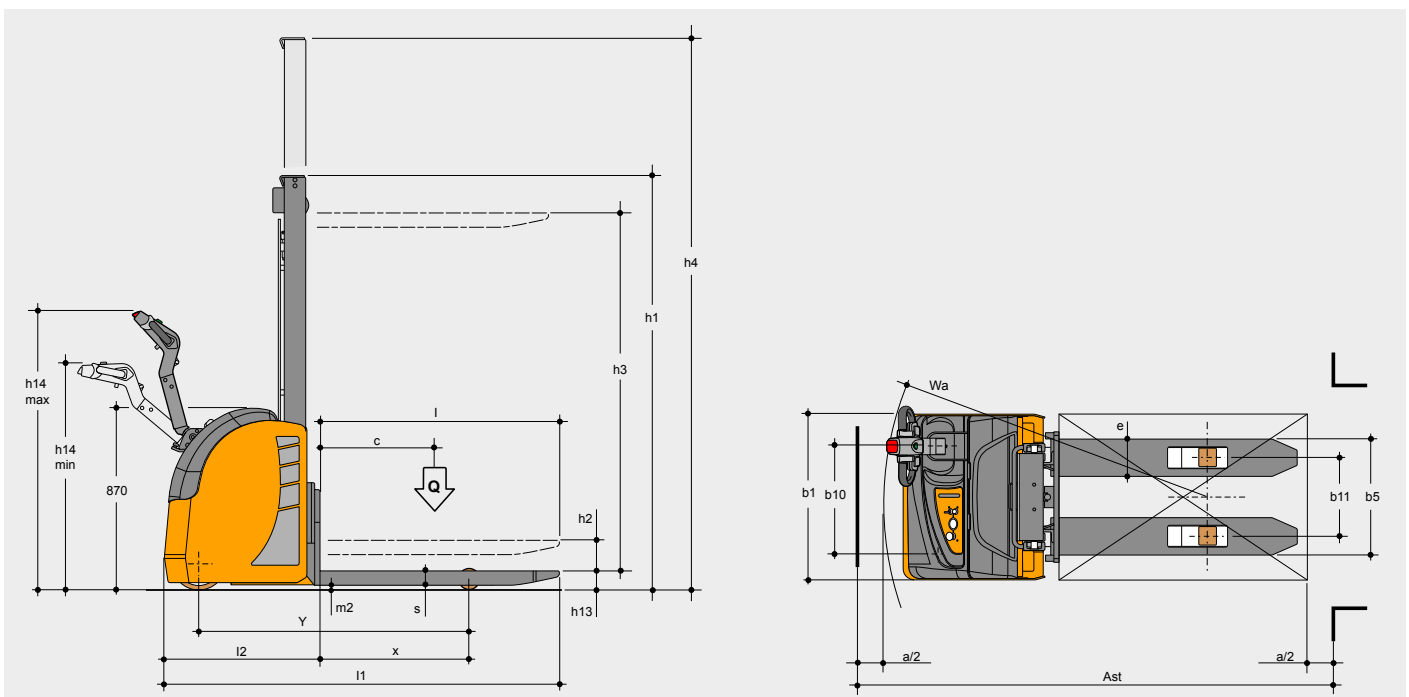



The configuration with four fixed points of support offers the maximum lateral stability granting the best safety and comfort levels during stacking and picking operations. The lifting / lowering by mini-joystick on tiller arm (for Logos ac only), ensures a precise and sensible load lifting and lowering, allows the operator to handle the load without taking the hands off the tiller arm. Exact and sensitive lifting of the load thanks to the hydraulic motor equipped with a flow regulation system reducing the noise level.



The battery compartment is easily accessed by simply lifting the hinged lid, thus facilitating daily and periodical battery checks and recharging. Logos ac is equipped with traction batteries up to 250 Ah. The standard built-in charger provides easy and reliable charging at any plug socket. Logos Light is equipped with starting batteries 12V 100Ah and can be equipped with semi-traction batteries 12V 100Ah as option.



OMG S.r.l.

Legal Seat:

Corso Buenos Aires,18 - 20124 Milano

Seat:

Via dell'Artigianato, 12 - 46023 Gonzaga (MN) Italy Tel. +39 0376 526011 Fax +39 0376 588008

www.omgindustry.com - info@omgindustry.com

